



MAY WHETTER & GROSE

**84D EAST HILL, ST. AUSTELL, PL25 4TR
OFFERS IN EXCESS OF £60,000**



LEASE EXTENSION AVAILABLE SUBJECT TO NEGOTIATION

IN A TUCKED AWAY POSITION, A SHORT DISTANCE FROM THE TOWN CENTRE AND REQUIRING A FULL REFURBISHMENT IS THIS ONE BEDROOM GROUND FLOOR APARTMENT, WHICH FORMS PART OF A BLOCK OF FOUR. BENEFITTING FROM PARKING, INTERNALLY OFFERS SHOWER ROOM, LOUNGE/DINER, KITCHEN AND A DOUBLE BEDROOM. VIEWING IS RECOMMENDED TO APPRECIATE IT'S CONVENIENT POSITION AND POTENTIAL. EPC - D.
SEE IMPORTANT AGENTS NOTES



Within walking distance of the centre of St Austell offering a wide range of shopping, educational and recreational facilities. There is a mainline railway station and leisure centre together with primary and secondary schools and supermarkets. The picturesque port of Charlestown and the award winning Eden Project are within a short drive. The town of Fowey is approximately 7 miles away and is well known for its restaurants and coastal walks. The Cathedral city of Truro is approximately 13 miles from the property.

Directions:

From St Austell town centre by either foot or car, head up East Hill, past Vospers Ford on the right hand side, approximately 50 yards past this you will notice the Cornwall Cricket Company. Turn in here and head down and the property will appear on the left hand side. A board will be at the front for identification.

The Accommodation:

All measurements are approximate, show maximum room dimensions and do not allow for clearance due to limited headroom.

Shower Room:

7'9" x 4'10" (2.37m x 1.48m)

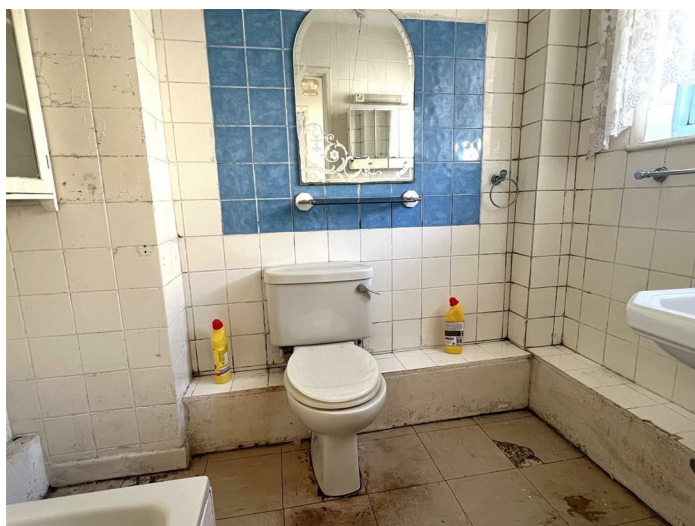

Single glazed frosted window to the front. Finished with a tiled wall surround and flooring. Comprising shower cubicle, WC and hand basin.

Main Living Area:

15'6" x 9'2" (4.74m x 2.81m)



Single glazed window to the front with electric heater beneath. Open arch through to kitchen.



From the communal parking area there is a covered canopy front porch, part glazed wood door into.

Entrance Hall:

Door into shower room, door into airing cupboard with slatted shelving housing the water cylinder and part glazed door into main living area.



Kitchen:

8'10" x 7'3" (2.71m x 2.21m)



With wall and base units, roll top laminated work surface incorporating stainless steel sink and drainer. Part tiled splash back surround and single glazed window. Space for white good appliances.

Bedroom:

8'4" x 15'6" (2.56m x 4.73m)



Single glazed window to the front with electric heater.



The apartment forms a block of four with communal parking.

Agents Notes:

WE UNDERSTAND THERE IS A COVENANT IN THE LEASE WHICH PRECLUDES ANYONE LETTING OR SUB LETTING THE THE FLAT - PLEASE ASK FOR INFORMATION

Ground Rent - £50pa

Maintenance Charges - £0 anything require will be split between apartments

Building Insurances £94.08 per apartment

Due to only approx. 65yrs left on the lease it would be cash buyers only at present HOWEVER we understand the Landlord is prepared to negotiate a lease extension subject to terms.

Floor Area

The floor area measurement is taken from the EPC.

Services

None of the services, systems or appliances at the property have been tested by the Agents.

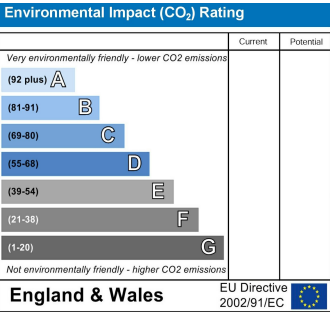
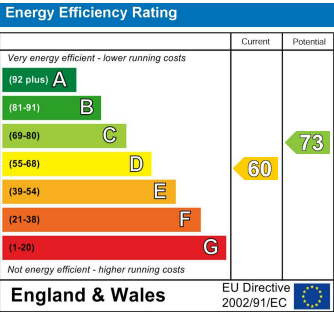



GROUND FLOOR

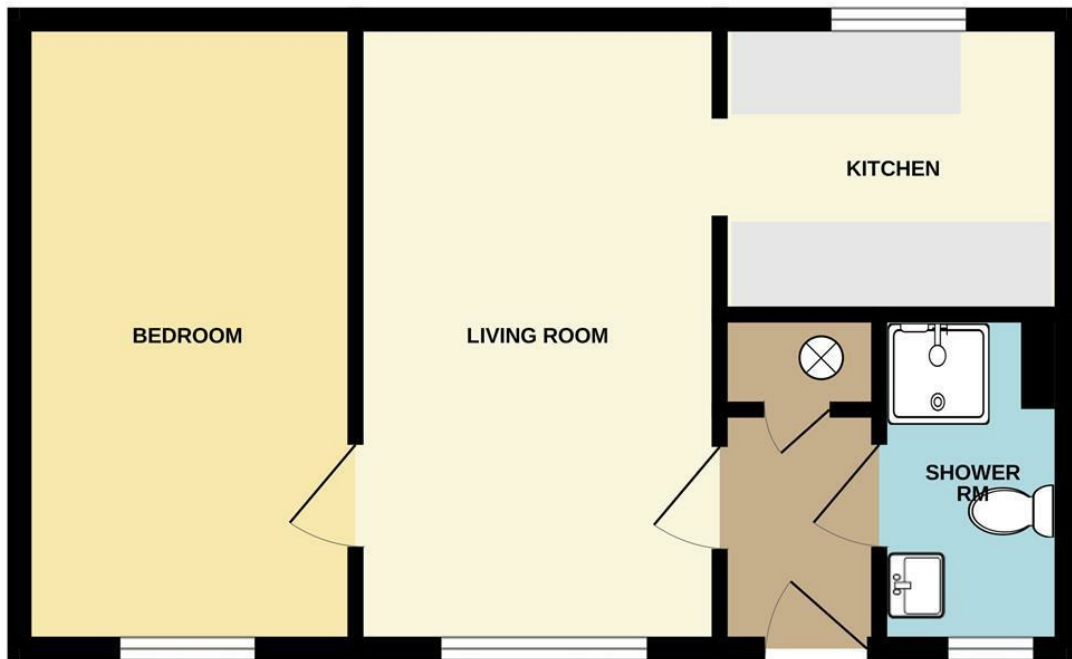

Whilst every attempt has been made to ensure the accuracy of the floorplan contained here, measurements of doors, windows, rooms and any other items are approximate and no responsibility is taken for any error, omission or mis-statement. This plan is for illustrative purposes only and should be used as such by any prospective purchaser. The services, systems and appliances shown have not been tested and no guarantee as to their operability or efficiency can be given.
Made with Metropix ©2024

Important Notice MISREPRESENTATION ACT 1989 and PROPERTY MISDESCRIPTIONS ACT 1991

Messrs. May, Whetter & Grose for themselves and for vendors and lessors of this property whose agents they are give notice that: (i) the particulars are set out as a general outline for the guidance of intended purchasers or lessees, and do not constitute, nor constitute part of, an offer or contract; ii) all descriptions, dimensions, reference to condition and necessary permissions for use and occupation, and other details are given without responsibility and any intending purchasers or tenants should not rely on them as statements or presentations of fact but must satisfy themselves by inspection or otherwise as to the correctness of each of them. (iii) no person in the employment of Messrs. May, Whetter & Grose has any authority to make or give any representation or warranty whatever in relation to the property.

